

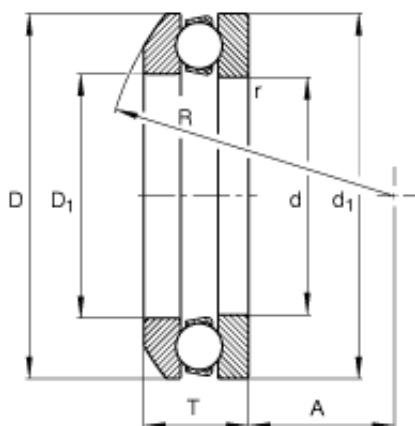

# NACHI BEARINGS TRAINING INDUSTRY



## FAG 53206 thrust ball bearings

Bearing No. 53206

Size	30x52x17.8 mm
Bore Diameter	30 mm
Outer Diameter	52 mm
Width	17,8 mm
d	30 mm
D	52 mm
T	17,8 mm
A	22 mm
D <sub>1</sub>	32 mm
D <sub>a max</sub>	42 mm
d <sub>1</sub>	52 mm
d <sub>a min</sub>	43 mm
R	45 mm
r <sub>a max</sub>	0,6 mm
r <sub>min</sub>	0,6 mm
m	0,147 kg / Weight
C <sub>a</sub>	25000 N / Dynamic load rating (axial)
C <sub>0a</sub>	46500 N / Static load rating (axial)
A	0,014 / Factor min. load
n <sub>G</sub>	7300 1/min / Limiting speed
C <sub>ua</sub>	2040 N / Fatigue limit load, axial

53206 Bearing 2D drawings and 3D CAD models