

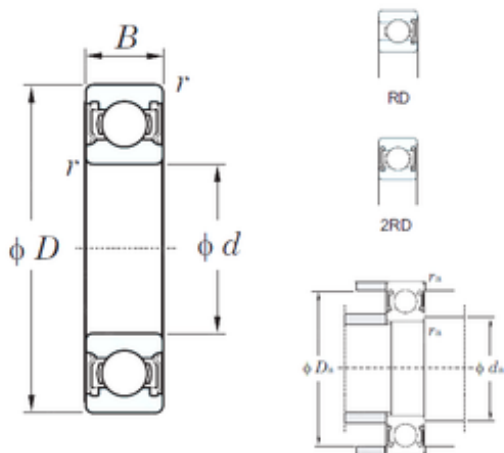

# NACHI BEARINGS TRAINING INDUSTRY



12 mm x 28 mm x 8 mm KOYO 6001-2RD deep groove ball bearings

Bearing No. 6001-2RD

Size	12x28x8 mm
Bore Diameter	12 mm
Outer Diameter	28 mm
Width	8 mm
d	12 mm
D	28 mm
B	8 mm
C	8 mm
r min.	0,3 mm
da min.	14 mm
da max	15 mm
Da max.	26 mm
ra max.	0,3 mm
Weight	0,022 Kg
Basic dynamic load rating (C)	5,1 kN
Basic static load rating (C0)	2,4 kN
(Grease) Lubrication Speed	24000 r/min

6001-2RD Bearing 2D drawings and 3D CAD models