

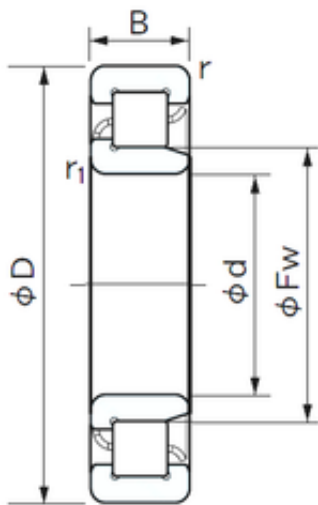

# NACHI BEARINGS TRAINING INDUSTRY



120 mm x 215 mm x 40 mm NACHI NJ 224 cylindrical roller bearings

Bearing No. NJ 224

Size	120x215x40 mm
Bore Diameter	120 mm
Outer Diameter	215 mm
Width	40 mm
d	120 mm
Fw	143.5 mm
D	215 mm
B	40 mm
r min.	2.1 mm
r1 min.	2.1 mm
Weight	5.61 Kg
Basic dynamic load rating (C)	260 kN
Basic static load rating (C0)	320 kN
(Grease) Lubrication Speed	2800 r/min

NJ 224 Bearing 2D drawings and 3D CAD models