

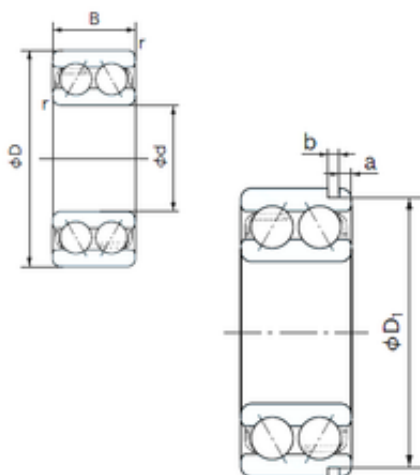

NACHI BEARINGS TRAINING INDUSTRY



30 mm x 62 mm x 23.8 mm NACHI 5206AN
angular contact ball bearings

Bearing No. 5206AN

Size	30x62x23.8 mm
Bore Diameter	30 mm
Outer Diameter	62 mm
Width	23.8 mm
d	30 mm
D	62 mm
B	23.8 mm
C	23.8 mm
a	3.28 mm
b	1.9 mm
r min.	1 mm
D1	59.61 mm
Weight	0.290 Kg
Basic dynamic load rating (C)	28,6 kN
Basic static load rating (C0)	20,5 kN
(Grease) Lubrication Speed	7000 r/min
Bore Type	Cylindrical Bore
Enclosure	Open
Configuration	Double Row
Bore Size	30 mm
Outside Diameter	62 mm
Width	23.8 mm
Fillet Radius/Chamfer	1 mm
Groove Width	1.9 mm
Groove Diameter	59.6 mm

5206AN Bearing 2D drawings and 3D CAD models



NACHI BEARINGS TRAINING INDUSTRY

a (max)	3.3 mm
Dynamic Load Rating	28,600 N
Static Load Rating	20,500 N
Limiting Speed - Grease	7,000 rpm
Limiting Speed - Oil	9,500 rpm
Radial Clearance	0.005 to 0.020 mm
da	36 mm
Da	56 mm
Dx	68.5 mm
ra	1 mm
Cy	4.7 mm