

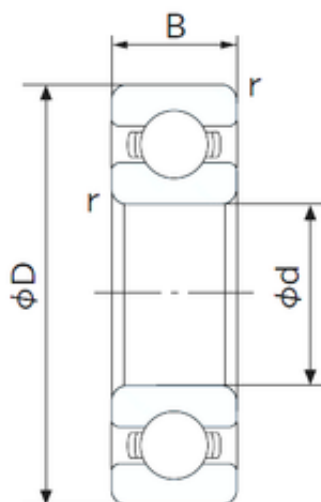

NACHI BEARINGS TRAINING INDUSTRY



20 mm x 37 mm x 9 mm NACHI 6904 deep groove ball bearings

Bearing No. 6904

6904 Bearing 2D drawings and 3D CAD models

Size	20x37x9 mm
Bore Diameter	20 mm
Outer Diameter	37 mm
Width	9 mm
d	20 mm
D	37 mm
B	9 mm
C	9 mm
r min.	0.3 mm
da min.	22 mm
Da max.	35 mm
ra max.	0.3 mm
Weight	0.036 Kg
Basic dynamic load rating (C)	6,35 kN
Basic static load rating (C0)	3,7 kN
(Grease) Lubrication Speed	19000 r/min
Category	Single Row Ball Bearings
Inventory	0.0
Manufacturer Name	NACHI
Minimum Buy Quantity	N/A
Weight / Kilogram	0.036
Product Group	B00308
Enclosure	Open
Precision Class	ABEC 1 ISO P0
Maximum Capacity / Filling	No



NACHI BEARINGS TRAINING INDUSTRY

Slot	
Rolling Element	Ball Bearing
Snap Ring	No
Internal Special Features	No
Internal Clearance	C0-Medium
Inch - Metric	Metric
Long Description	20MM Bore; 37MM Outside Diameter; 9MM Outer Race Diameter; Open; Ball Bearing; ABEC 1 ISO P0; No Filling Slot; No Snap Ring; No Internal Special Features
Category	Single Row Ball Bearing
UNSPSC	31171504
Harmonized Tariff Code	8482.10.50.68
Noun	Bearing
Keyword String	Ball
Manufacturer URL	http://www.nachi.com
Weight / LBS	0.08
Bore	0.787 Inch 20 Millimeter
Outer Race Width	0.354 Inch 9 Millimeter
Outside Diameter	1.457 Inch 37 Millimeter
Bore Type	Cylindrical Bore
Configuration	Single Row
Bore Size	20 mm
Width	9 mm
Fillet Radius/Chamfer	0.3 mm
Dynamic Load Rating	6,350 N
Static Load Rating	3,700 N
Limiting Speed - Grease	19,000 rpm
Limiting Speed - Oil	23,000 rpm
Factor fo	14.8
Radial Clearance	0.005 to 0.020 mm



NACHI BEARINGS TRAINING INDUSTRY

da (min)	22 mm
Da (max)	35 mm
ra (max)	0.3 mm